

## TERMINALS

### ORTAC PLASTIC SCREW TERMINALS

**Material** : Polyamide  
Polycarbonate  
Polyethylene

**Insert** : Brass, nickel plated

**Temperature** : -20 +100 °C

**Current rating** : EN 60998-2-1  
24 Amp

**Voltage rating** : 400 V

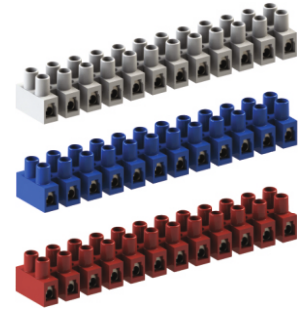
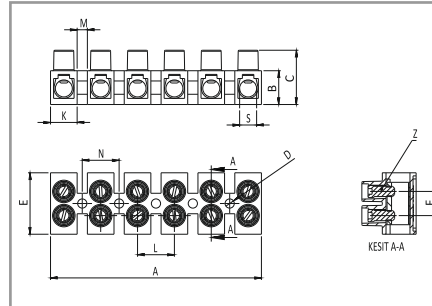

White version is certified by TSE

Code	Type mm.	Size	Number of ways	A mm.	B mm.	C mm.	D mm.	E mm.	F mm.	K mm.	L mm.	M mm.	N mm.	S mm.	Z mm.
YPLS 01	2,5 - 4	01	12	117,5	10	17,5	3,5	19,5	7,6	6,5	10	3,5	10	4,5	M 3
YPLS 02	4 - 6	02	12	135	10,5	18,7	4	21,3	8,6	7,7	11,6	4	11,6	5,5	M 3,5
YPLS 03	6 - 10	03	10	142	12,5	21,5	4	22	10,2	10	14,5	4,5	14,7	7	M 4
YPLS 04	10 - 16	04	6	97,5	15,2	25	5	30	11,5	11,85	16,85	5	14,85	9	M 5
YPLS 05	16 - 25	05	6	103,5	16,7	26,7	5	30	11,8	13	18	5	18	10	M 5

## WIRE CONNECTORS

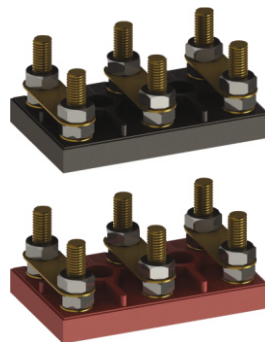
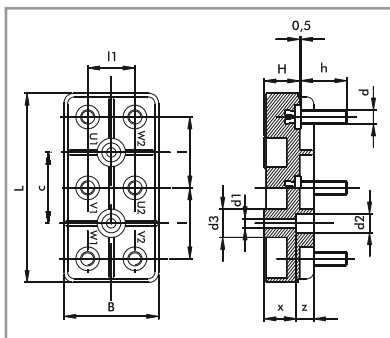

### ORTAC WIRE CONNECTORS

**Material** : Polyamide V2  
V0 (optional)  
+ Glass fibre reinforced

**Colour** : Brown  
Black

**Permanent operational temp.** : -20 +100 °C

**Short term max. operational temp.** : -30 +150 °C

Type	Brown Code	Black Code	L mm.	B mm.	H mm.	I mm.	l1 mm.	c mm.	d mm.	h mm.	x mm.	z mm.	d1 mm.	d2 mm.	d3 mm.
56 - 63	MKE 01	MK01	40	25	8,5	15	15	15	M 4	15	4	6	4,5	8	11
71 - 80	MKE 02	MK02	50	30	8,5	20	20	20	M 4	15	4	7,5	6,3	10,5	14,8
132	MKE 03	MK03	60	37	10	23	23	23	M 5	19	6,5	7,5	6,3	10,5	14,8
160 - 180	MKE 04	MK04	72	44	12	28	28	28	M 6	24	8,5	7,5	6,5	10,5	15,8
225 - 250	MKE 05	MK05	91	56	12,5	35	35	35	M 8	28	10	7,5	6,5	10,5	15,8
280	MKE 06	MK06	115	70	15,5	45	45	45	M 10	34	10,5	11	9,5	15,5	21,8